

### Press Fit Guide Pins - Ground

DIECO Part #	D1	L1	L2
TPC750X4*	3/4"	4	1 3/8"
TPC750X4.5		4 1/2	
TPC750X5*		5	
TPC750X5.5		5 1/2	
TPC750X6		6	
TPC750X6.5		6 1/2	
TPC750X7		7	
TPC750X7.5		7 1/2	
TPC750X8		8	
TPC875X4	7/8"	4	1 1/2"
TPC875X4.5		4 1/2	
TPC875X5		5	
TPC875X5.5		5 1/2	
TPC875X6		6	
TPC875X6.5		6 1/2	
TPC875X7		7	
TPC875X7.5		7 1/2	
TPC875X8		8	
TPC100X4	1"	4	1 1/2"
TPC100X4.5*		4 1/2	
TPC100X5*		5	
TPC100X5.5*		5 1/2	
TPC100X6*		6	
TPC100X6.5*		6 1/2	
TPC100X7		7	
TPC100X7.5		7 1/2	
TPC100X8		8	
TPC100X8.5		8 1/2	
TPC100X9	9		
TPC100X10	10		
TPC125X4	1 1/4"	4	1 3/4"
TPC125X4.5		4 1/2	
TPC125X5		5	
TPC125X5 1/2		5 1/2	
TPC125X6		6	
TPC125X6.5*		6 1/2	
TPC125X7		7	
TPC125X7.5		7 1/2	
TPC125X8		8	
TPC125X8.5		8 1/2	
TPC125X9		9	
TPC125X9-1/2		9 1/2	
TPC125X10		10	
TPC125X11		11	
TPC125X12	12		
TPC150X4-1/2	1 1/2"	4 1/2	2"
TPC150X5		5	
TPC150X5.5		5 1/2	
TPC150X6		6	
TPC150X6-1/2		6 1/2	
TPC150X7*		7	
TPC150X7.5		7 1/2	
TPC150X8		8	
TPC150X8.5		8 1/2	
TPC150X9		9	
TPC150X9.5	9 1/2		
TPC150X10	10		
TPC150X11	11		
TPC150X12	12		
TPC150X13	13		

DIECO Part #	D1	L1	L2		
TPC150X8*	1 1/2"	8	2"		
TPC150X8.5		8 1/2			
TPC150X9		9			
TPC150X9.5		9 1/2			
TPC150X10		10			
TPC150X11		11			
TPC150X12		12			
TPC175X6		1 3/4"		6	2 1/4"
TPC175X6.5				6 1/2	
TPC175X7				7	
TPC175X7.5				7 1/2	
TPC175X8				8	
TPC175X8.5	8 1/2				
TPC175X9	9				
TPC175X9.5	9 1/2				
TPC175X10	10				
TPC175X11	11				
TPC175X12	12				
TPC175X13	13				
TPC175X14	14				
TPC175X15	15				
TPC175X17	17				
TPC200X6	2"	6	2 1/2"		
TPC200X6.5		6 1/2			
TPC200X7		7			
TPC-200X7.5		7 1/2			
TPC200X8		8			
TPC200X8.5		8 1/2			
TPC200X9		9			
TPC200X9.5		9 1/2			
TPC200X10		10			
TPC200X11		11			
TPC200X12	12				
TPC200X13	13				
TPC200X14	14				
TPC200X15	15				
TPC200X17	17				
TPC200X19	19				
TPC250X8	2 1/2"	8	3 1/2"		
TPC250X8.5		8 1/2			
TPC250X9		9			
TPC250X10		10			
TPC250X11		11			
TPC250X12		12			
TPC250X13		13			
TPC250X14		14			
TPC250X15		15			
TPC250X17		17			
TPC250X19	19				
TPC250X21	21				
TPC300X9	3"	9	4"		
TPC300X10		10			
TPC300X11		11			
TPC300X12		12			
TPC300X13		13			

DIECO Part #	D1	L1	L2
TPC300X14	3"	14	4"
TPC300X15		15	
TPC300X17		17	
TPC300X19		19	
TPC300X21		21	

\* Quick Fit Style (MQF) available

### Press Fit Guide Pins - Straight

DIECO Part #	D1	L1	
TN750X4	3/4"	4	
TN750X4.5		4 1/2	
TN750X5		5	
TN750X6		6	
TN750X7		7	
TN750X8		8	
TN100X4		1"	4
TN100X4.5			4 1/2
TN100X5	5		
TN100X5.5	5 1/2		
TN100X6	6		
TN100X6.5	6 1/2		
TN100X7	7		
TN100X7.5	7 1/2		
TN100X8	8		
TN100X8.5	8 1/2		
TN100X9	9		
TN100X10	10		
TN125X4.5	1 1/4"	4 1/2	
TN125X5		5	
TN125X5.5		5 1/2	
TN125X6		6	
TN125X6-1/2		6 1/2	
TN125X7		7	
TN125X7.5		7 1/2	
TN125X8		8	
TN125X8.5		8 1/2	
TN125X9		9	
TN125X9.5		9 1/2	
TN125X10		10	
TN125X11	11		
TN125X12	12		
TN150X5	1 1/2"	5	
TN150X5.5		5 1/2	
TN150X6		6	
TN150X6.5		6 1/2	
TN150X7		7	
TN150X7.5		7 1/2	
TN150X8		8	
TN150X8.5		8 1/2	
TN150X9		9	
TN150X9.5		9 1/2	
TN150X10	10		
TN150X11	11		
TN150X12	12		

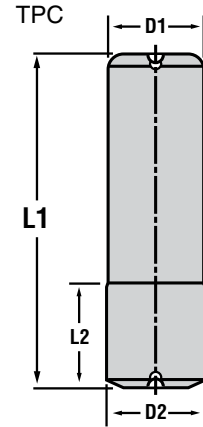

L1 (overall length)  
L2 (pressed fit length)

**D2 Specifications:**  
 TPC-100 & smaller = nominal plus .0020 +.0000  
 TPC-125 - 300 = -.0006 nominal plus .0025 +.0000  
 TPC-375 & 450 = -.0008 nominal plus .0025 +.0000  
 -.0010

Also available in  
**UNGROUND - TPB**  
 All TPB Guide Pins have  
 centers & .015 grind stock  
 on the D2 diameter.  
 Change part number  
 to TPB instead  
 of TPC.

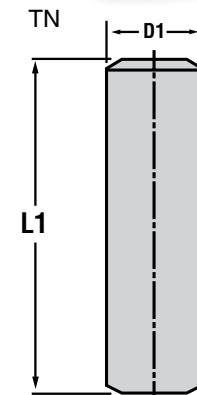

TN Pins are centerless ground