

- Bushing shoulder ground square to press fit diameter assists in obtaining correct alignment when properly seated against ground surface of punch holder
- Ground lead on press fit end starts bushing accurately into punch holder
- Lubrication fitting at intersection of double figure-eight grooves allow for simple, effective lubrication
- A nominal allowance is provided on the inside diameter for honing after assembly

PRODUCTO Shoulder Bushing - Press Fit

Nominal I.D.	Press Fit				Regular Shoulder			Long Shoulder		
	I.D. A	O.D. B	C	E	DIECO Part #	F	L	DIECO Part #	F	L
3/4	0.7503	1.1270	1.34	0.8	BSH-MB6	1.00	1.87			
	0.7504	1.1265	1.34	0.62	BSH-MB6A	1.00	1.62			
1	1.0003	1.5020	1.72	1.12	BSH-MB8	1.75	2.87	BSH-MBL8	2.75	3.87
1 1/4	1.2503	1.7525	1.97	1.25	BSH-MB10	2.00	3.25			
1 1/2	1.5004	2.0025	2.22	1.37	BSH-MB12	2.00	2.93			
2	2.0005	2.5030	2.97	1.87	BSH-MB16	2.00	3.87			

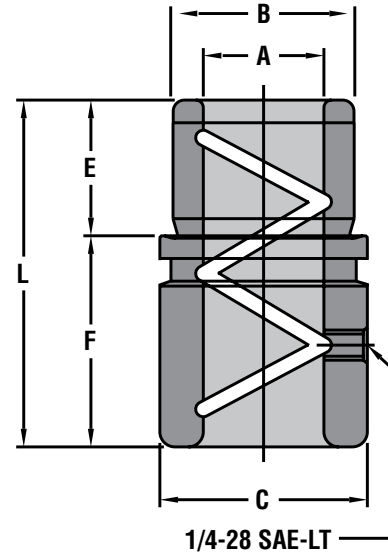

PRODUCTO Shoulder Bushing - Removable

Nominal I.D.	I.D. A	O.D. B	C	E	F	L	DIECO Part #
3/4	0.7503	1.1252	1.34	0.8	1.00	1.87	BSH-MBR6
1	1.0003	1.5002	1.72	1.12	1.75	2.87	BSH-MBR8
1 1/4	1.2503	1.7502	1.97	1.25	2.00	3.25	BSH-MBR10

Furnished with clamps and screws.

PRODUCTO Straight Bushing - Press Fit

Nominal I.D.	I.D. A	O.D. B	Short		Long	
			DIECO Part #	L	DIECO Part #	L
1/2	0.5003	0.7520	BSH-MA4	1.50		
	0.5004	0.7515				
3/4	0.7503	1.1270	BSH-MA6	1.75	BSH-MC6	3
	0.7504	1.1265				
1	1.0003	1.5020			BSH-MC8	3
	1.0004	1.5015				

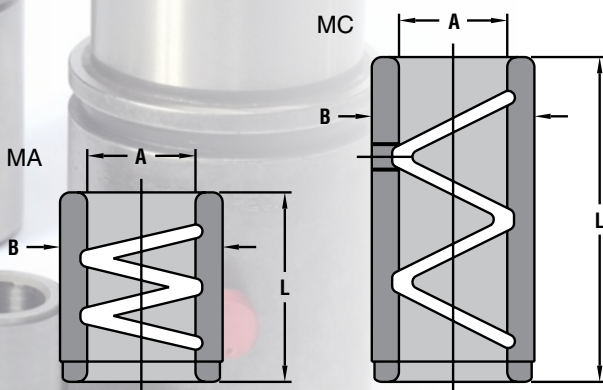

PRODUCTO Clamp Arrangement

Nominal I.D.	Clamp Type	No. of Clamps	Cap Screw	P	O	U
0.75	D50	2	1/4 - 20	0.91	1.22	0.62
1.00	D50	2	1/4 - 20	1.09	1.40	0.62
1.25	D50	3	1/4 - 20	1.22	1.53	0.62
1.50	D50	3	1/4 - 20	1.34	1.65	0.62
2.00	LD50	4	5/16 - 18	1.76	2.08	0.75

